



Replace this box with PI statement as per spec.  
Replace this box with PI statement as per spec.  
Replace this box with PI statement as per spec.  
Replace this box with PI statement as per spec.



M13866-B22

1

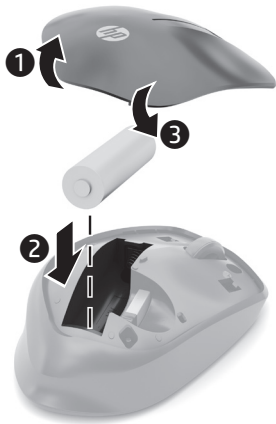

2

Connect to a USB port on your computer.

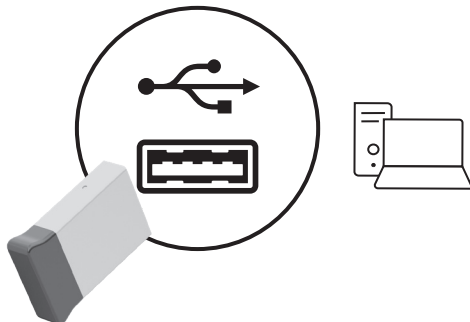

وَصَلِّهْ بِمِنْفَذِ USB الْمَوْجُودِ عَلَى  
جِهَازِ الْكَمْبِيُوتَرِ لَدَيْكَ.

Sambungkan ke port USB pada  
komputer.

Свържете към USB порт на  
компютъра си.

Připojte k portu USB na  
počítači.

Tilslut til en USB-port på din  
computer.

Zum Anschließen an einen  
USB-Anschluss am Computer.

Conéctelo a un puerto USB en  
su equipo.

Συνδέστε σε μια θύρα USB  
του υπολογιστή.

Se branche sur un port USB de  
votre ordinateur.

Priključite u USB priključak na  
računalu.

Collegare a una porta USB del  
computer.

Компьютердеги USB портына  
жалғаңыз.

Izveidojiet savienojumu ar sava  
datora USB pieslēgvietu.

Prijunkite prie savo kompiuterio  
USB lizdo.

Csatlakoztassa a számítógép  
egyik USB-portjához.

Aan te sluiten op een USB-poort  
op uw computer

Koble til en USB-port på  
datamaskinen.

Podłącz do portu USB  
w komputerze.

Ligar a uma porta USB no seu  
computador.

Conecte a uma porta USB no  
computador.

Efectuați conexiunea la un port USB  
de la computerul dumneavoastră.

Подключите к порту USB  
компьютера.

Zapojte do portu USB na  
počítači.

Za priključitev v vrata USB na  
računalniku.

Yhdistä tietokoneesi  
USB-porttiin.

Povežite sa USB portom na  
računaru.

Anslut till en USB-port på din dator.

เชื่อมต่อตัวรับพอร์ต USB บนคอมพิวเตอร์  
ของคุณ

Bilgisayarınızda bulunan bir USB  
bağlantı noktasına takın.

Підключіть до порту USB на  
комп'ютері.

コンピューターのUSBポートに接  
続します。

컴퓨터의 USB 포트에  
연결합니다.

连接到计算机上的 USB  
端口。

連接至電腦上的 USB  
連接埠。

3

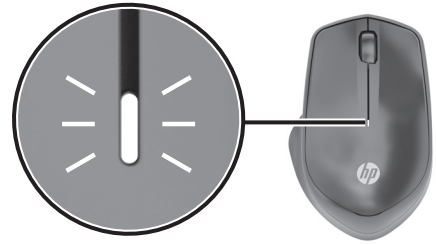
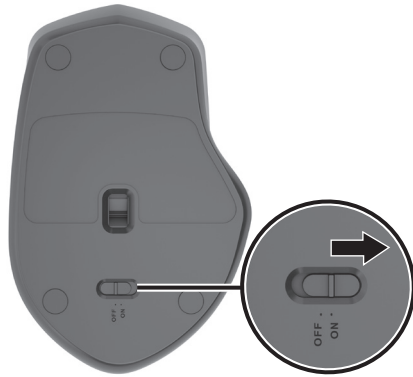

70070/SDPPI/2020  
2141



Dilarang melakukan perubahan spesifikasi yang dapat menimbulkan gangguan fisik dan/atau elektromagnetik terhadap lingkungan sekitarnya

RMN/型號/型号: HSA-P011M + HSA-P011D

© Copyright 2020 HP Development Company, L.P.

The information contained herein is subject to change without notice. The only warranties for HP products and services are set forth in the express warranty statements accompanying such products and services. Nothing herein should be construed as constituting an additional warranty. HP shall not be liable for technical or editorial errors or omissions contained herein.

Second Edition: October 2020

First Edition: July 2020